



## Public Notice

Road Closure: Between Concession 8 & 9 North Elmsley, Rideau Ferry Road

**TAKE NOTICE** that the Council of Township of Drummond/North Elmsley proposes the passage of a by-law to stop up, close and sell a certain portion of an unopened road allowance which is no longer required for municipal purposes on August 13, 2019 at 5:00 p.m. Any person who believes he or she may be adversely affected by the closure of the unopened road allowance has an opportunity to express his or her concerns at an open meeting at the Township Municipal Office, 310 Port Elmsley Road.

### DESCRIPTION OF PROPOSED CLOSING

The portion of the unused public street right-of-way road allowance, legal description is:  
RDAL BTN CON 8 & 9 NORTH ELMSLEY ABUTTING LT 25 CON.

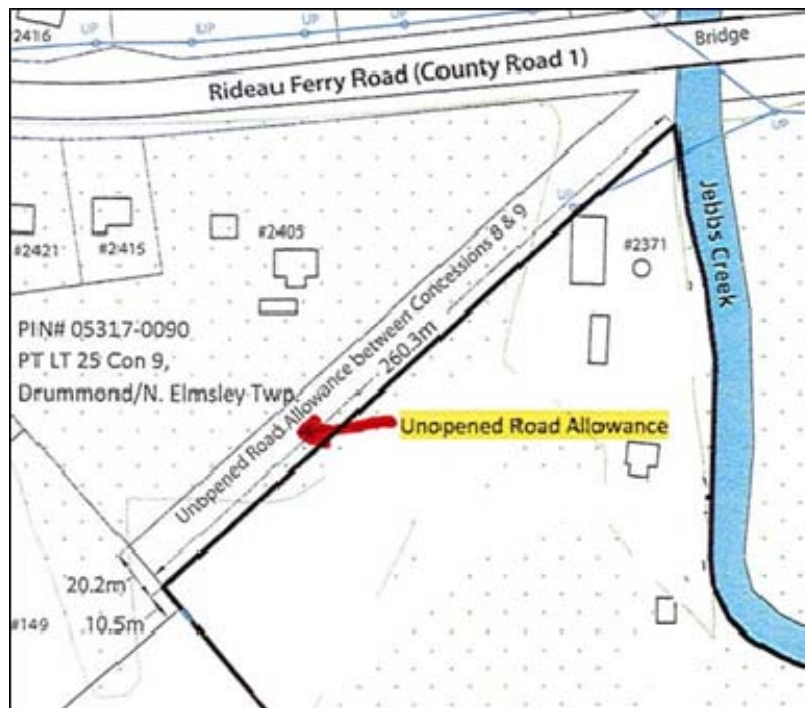

Contact: Cathy Ryder, Deputy Clerk  
Email: [cryder@dnetownship.ca](mailto:cryder@dnetownship.ca)  
Phone: 613-267-6500